

# MIDLUM MV15 & MV16



[www.macktrucks.com.au](http://www.macktrucks.com.au)

## SPECIFICATION SUMMARY

GVM	15,000 kg 16,000 kg
GCM	24,000 kg
Engine	Renault dCi 6 270 195 kW @ 2,400 rpm 900 Nm from 1,200 to 1,700 rpm
Wheelbases	4,550 mm 5,150 mm 5,750 mm 6,480 mm
Pallets	10 – 14
Brakes	Disc Front and Rear

# MACK – WE'RE ON THE MOVE

## ENGINE & TRANSMISSION

### ENGINE MODEL

RENAULT dCi 6 270  
6.18 litre, 6 cylinder  
195 kW power @ 2,400 rpm  
900 Nm torque from 1,200 to 1,700 rpm  
Turbo charged and intercooled

### ENGINE BRAKE / RETARDER

Engine exhaust brake (air operated)

### AIR INTAKE & FILTER

Single element dry type air cleaner with remote air intake at the rear of the cab on RHS

### FILTERS

Oil : Single spin-on disposable  
Fuel : Single spin-on disposable  
Both engine mounted

### AIR COMPRESSOR

Single cylinder 250 cm<sup>3</sup> air compressor

### ALTERNATOR

24 Volt, 60 Amp

### STARTER

24 Volt electric starter motor  
Key type start & stop

### BATTERIES

Two heavy duty 12 Volt, 140 Ah  
Battery isolation switch

### FAN

9 blade nylon fan, thermostatically controlled

### EXHAUST

Single vertical exhaust post mounted on LHS with longitudinal muffler

### TRANSMISSION

EATON FULLER FS 6309 A  
Synchromesh 9 speed direct transmission  
Forward gears : 9      Reverse gears : 1  
High : 1.00      Low : 12.57

### CLUTCH

MFZ 395 mm  
Single dry plate, Automatic adjustment  
Air assisted hydraulic actuation

## FRONT & REAR AXLES

### FRONT AXLE

RENAULT E62 AD  
Nominal capacity : 6,000 kg

### FRONT SUSPENSION

Two 2-leaf parabolic springs with shock absorbers and anti-roll bar

### FRONT BRAKES

Air actuated ventilated discs, Automatic adjust  
Warning light for each disc shows on dashboard

### STEERING GEAR

ZF 8095 integral hydraulic power steering

### REAR AXLE

RENAULT P 1120 SLB  
Nominal capacity : 10,500 kg  
Single Reduction, Ratio 3.15 : 1

### REAR SUSPENSION

MV15 : Two 3-leaf parabolic springs with shock absorbers and anti-roll bar  
Nominal capacity : 11,500 kg

MV16 : HENDRICKSON air suspension with two electronically controlled air bags  
Remote control allows chassis height to be varied from inside or outside  
Range of adjustment : 175 mm (+105 mm / -70 mm)  
Nominal capacity : 10,500 kg

### REAR BRAKES

Air actuated ventilated discs, Automatic adjust  
Warning light for each disc shows on dashboard  
Dual line air with spring emergency brakes and emergency release hand control brake valve  
Single element brake air drier

### DRIVELINE

EATON SPICER SPL

### WHEELS

Front & Rear : 8-stud 275 mm PCD steel disc  
19.5" x 8.25"

### TYRES

Front : MICHELIN XZE-2 305/70R19.5  
Rear : MICHELIN XDE-2 305/70R19.5  
Spare wheel and tyre to match steer  
Carrier mounted in afterframe  
Jack and handle

## CHASSIS

### FRAME

Single rail ladder type channel  
220 mm x 70 mm x 7 mm (4,550 mm)  
Tensile strength : 500 N/mm<sup>2</sup>  
220 mm x 70 mm x 8 mm (5,000 mm or >)  
Tensile strength : 610 N/mm<sup>2</sup>  
Width 850 mm  
Front towing pin on LH chassis rail  
Pre-fitted raised body mounting brackets

### WHEELBASE OPTIONS

4,550 mm with 2,690 mm afterframe  
5,150 mm with 3,090 mm afterframe  
5,750 mm with 3,450 mm afterframe  
6,480 mm with 3,700 mm afterframe

### CAB MOUNTS

Front : Two pivot mounts  
Rear : Two spring mounts with shock absorbers

### FRONT BUMPER

Grey plastic bumper with two step access

### AIR TANKS

Three steel air tanks mounted on LH chassis rail

### FUEL TANK

Single 300 litre (246 kg diesel)  
steel polygonal tank on RHS

### BATTERY MOUNT

Battery box with plastic cover mounted on LH chassis rail

## CAB

### GLOBAL CAB

400 mm space behind seats  
2 additional interior overhead lights  
Privacy curtain

### EXTERIOR

Cataphoretically anti-rust treated shell  
ECE 29 crash test  
Tinted laminated flush bonded windscreen  
External sunvisor  
107° front radiator grille opening  
60° hydraulic cab tilt with kerbside controls and auto lock down mechanism  
Two illuminated anti-slip staircase style steps  
90° opening wide entry doors  
Full sound and thermal insulation  
Remote keyless entry and central locking

### INTERIOR

Trim : Lichen cloth fabric (Scotchguarded)  
Dashboard : Black plastic fascia panel  
White on black gauges  
Floor : Gravel fleck rubber mat  
Sound system : BLAUPUNKT Radio CD with Steering column controls

### INSTRUMENTS / GAUGES

Speedometer / Odometer (electronic)  
Tachometer (electronic), Digital clock  
Dual air pressure, Fuel level, Lighting rheostat  
Engine coolant and oil pressure

### INTERNAL EQUIPMENT

Power windows (LH & RH)  
3 piece internal sunvisor  
2 overhead glove boxes  
Centre storage console including drink holder (mounted on back of centre seat if fitted)  
Door pockets on both doors  
Easy entry grab handles  
Turn signal levers with automatic return  
Cigarette lighter and ashtray  
12 Volt socket  
Interior access to fuses and relays

### ELECTRICAL PRE-DISPOSITIONS FOR BODYWORK

3 dash warning lights for body equipment  
Single connector/isolator for electrical supply to bodywork  
Modular side marker-light units

CLIMATE CONTROL

Fully integrated air conditioning  
4 speed fan with heater setting and outlets for face, floor, windscreen and side windows

COURTESY LAMPS

2 fixed and 2 directional lamps with Off/Door/On switch

HEADLAMPS

Two dual lens headlamps, recess mounted in pivoting array offering easy access for cleaning and bulb replacement, Electronic dip and headlight beam angle adjustment from driving position

HORN

Electric : Dual single tone

MARKER LAMPS

2 roof mounted clear lamps

MIRRORS

Power adjustable aerodynamic anti-vibration heated side mirrors with LH wide angle and kerb view mirrors

SEATS

Driver : ISRINGHAUSEN  
Adjustable air suspended seat with integrated 3 point retractable lap sash belt  
  
Passenger : Dual passenger seat increasing cab capacity to three

STEERING WHEEL

Soft touch 460 mm (18.1") diameter with A4 writing platform  
Adjustable tilt steering column

WINDSHIELD WIPERS

Electric variable speed and intermittent incorporating wash jets with washer reservoir mounted behind grille above LH headlight

PAINT

TYPE & COLOUR

Cab : Glacier White (PPG 1S045)  
Chassis : Grey

BASE SPECIFICATION DATA	
TARE WEIGHT – MV15	
FRONT	3,232 kg
REAR	1,499 kg
TOTAL	4,731 kg
TARE WEIGHT – MV16	
FRONT	3,158 kg
REAR	1,587 kg
TOTAL	4,745 kg
Tare weights calculated on base specification and full fuel tank	

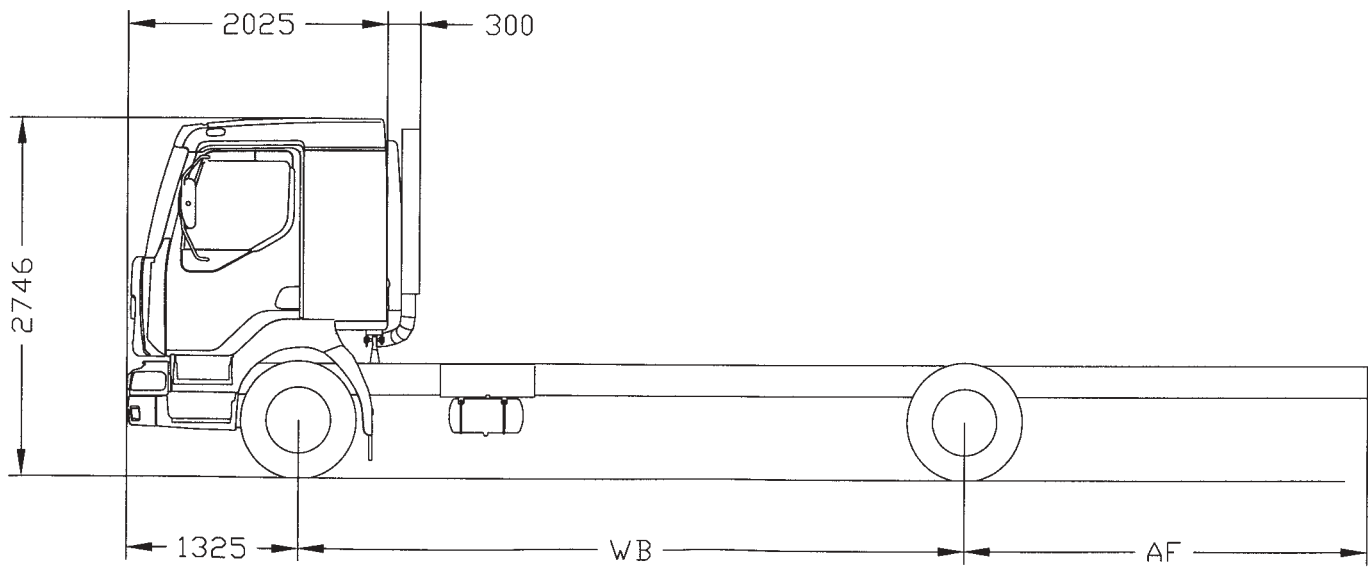

Global cab with bunk



Steering wheel adjustment



AXLE LOAD CAPACITIES			
	FRONT	REAR MV15	REAR MV16
Axle	6,000	10,500	10,500
Suspension	6,000	11,500	10,500
Tyres	6,150	10,900	10,900
LOAD LIMIT	6,000	10,500	10,500

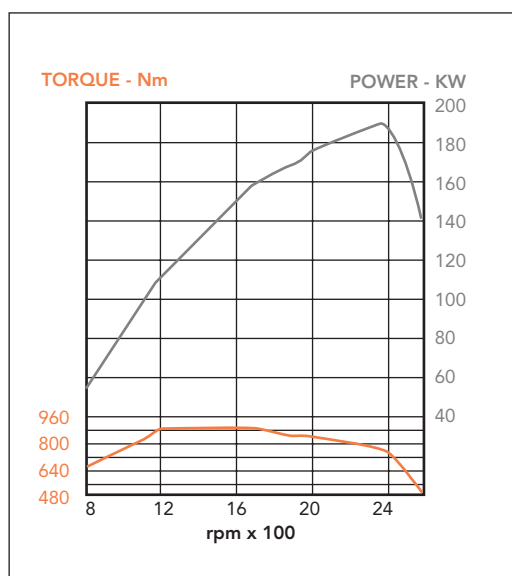

[www.macktrucks.com.au](http://www.macktrucks.com.au)

Mack Trucks Australia Pty Ltd

A.B.N. 41 009 719 582

20 Westgate Street, Wacol QLD 4076 AUSTRALIA

Ph: (07) 3718 3500 Fax: (07) 3718 3392

January 2004

The information in this brochure was current at the time of publication. Mack Trucks Australia Pty Ltd reserves the right to make changes in specifications, equipment, and design, or to discontinue models, options or extras without notice at any time.